

INTRODUCING

SAVANT SMART BUDGET

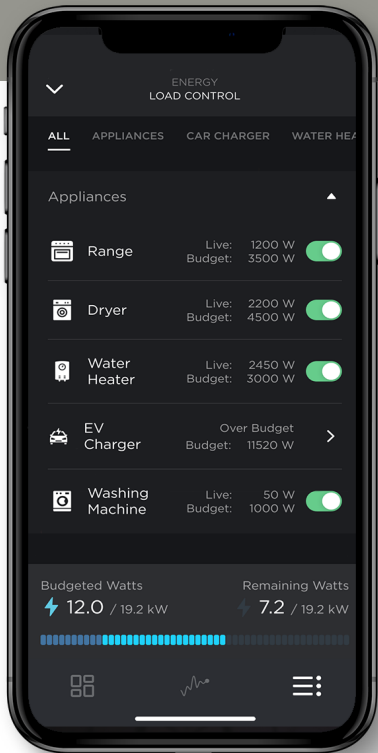

Smart Budget Energy Management in the Savant App



Avoid costly service upgrades with the Savant Power System

Homeowners now have an opportunity to electrify more of their everyday essentials, from vehicles to appliances. However, at least 50 million U.S. homes have limited electrical services and can only support new electrical loads through costly and drawn-out service upgrades.

Savant is the smart alternative to an electrical service upgrade. By installing just a few Savant Power Modules in the home's existing electrical panel, homeowners can coordinate power for their essentials while introducing new appliances, heat pumps, EV chargers, and more.

The Savant app allows homeowners to learn about their energy trends and personalize how they want to make smarter use of their power. Whether on-demand or on a schedule, Savant's Smart Budget feature prioritizes how power is used in the home by monitoring live consumption, shedding unnecessary loads, and balancing usage within a limited electrical service.

The Savant Power System distributes power intelligently throughout the home

Savant is on a mission to help homeowners manage power across the home, from circuit-level to subsystems, EV chargers to energy storage. Utilities, home builders, and energy professionals can leverage these solutions on scale to deliver secure, sustainable power to homes nationwide.

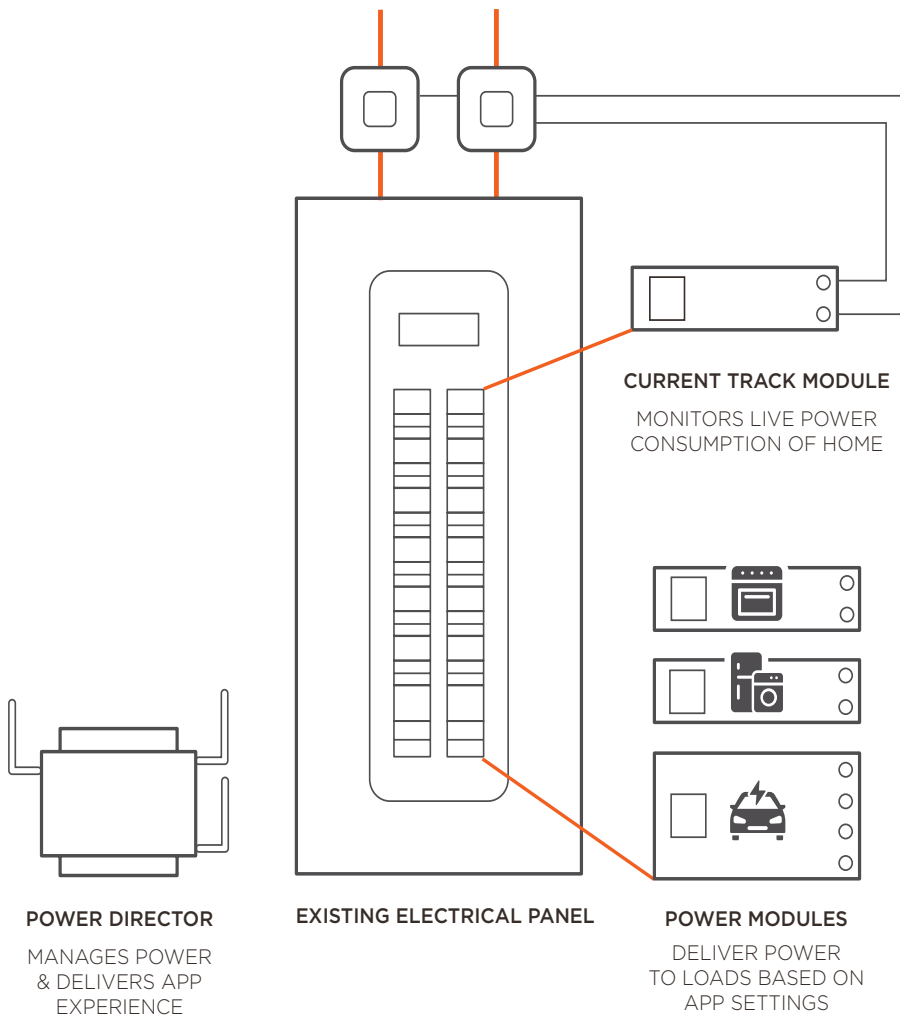
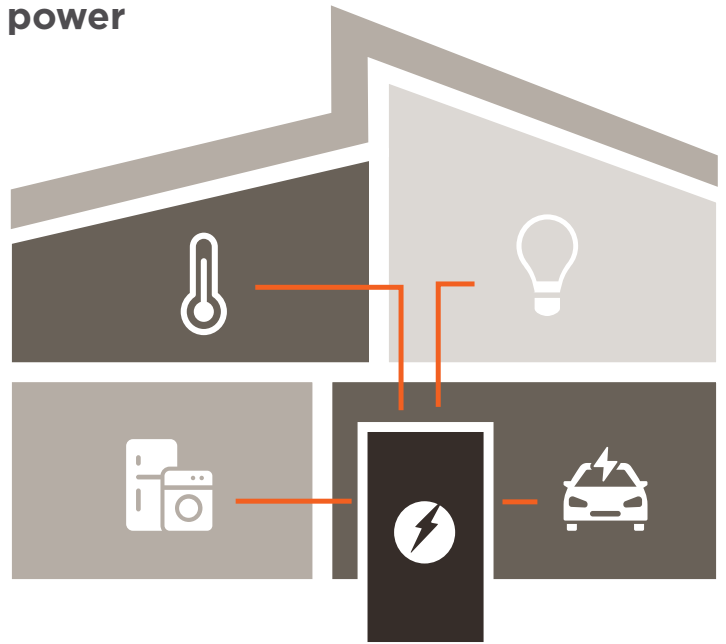

Savant Power Modules work with all major circuit breaker panel manufacturers, ensuring scalability and ease of installation.